

# DELHI

## BIDI SERIES

### ***Backward Inclined DWDI Blower***

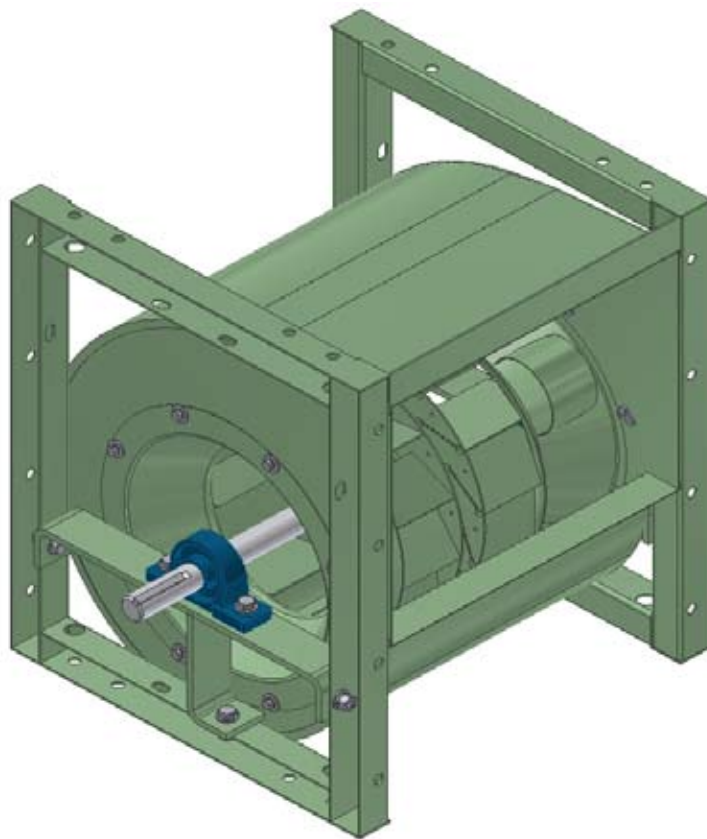

Delhi Industries certifies that the BIDI Series shown herein are licensed to bear the AMCA Seal. The ratings shown are based on tests and procedures performed in accordance with AMCA Publications 211 and comply with the requirements of the AMCA Certified Ratings Programme.



## BIDI Series

Double Width, Double Inlet Backward Inclined Blower

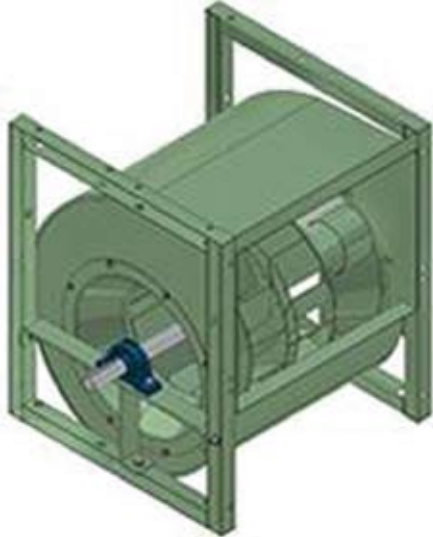

### Features:

- Welded backwardly inclined blades
- Cold rolled steel housing with green, weather resistant, high solids air dried enamel
- Cast iron pillow block bearings
- Heavy, welded steel 'U' channel frames with T bar bearing supports for universal 4 way mounting
- Detachable inlet venturi
- Shafts have corrosion inhibiting coating and are keywayed both ends

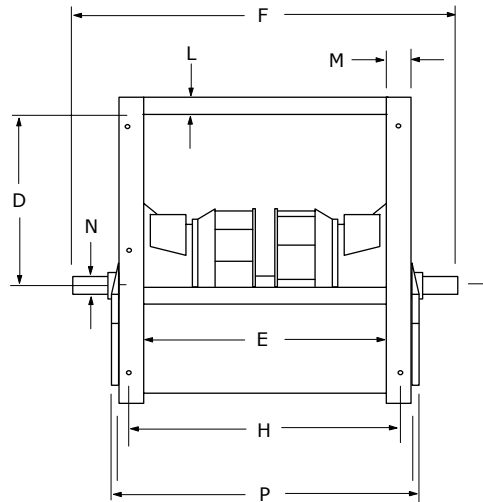
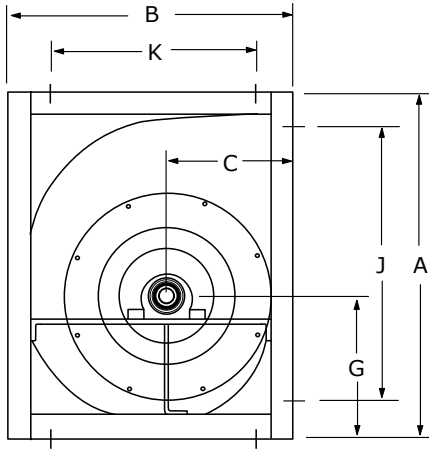

### Optional:

- 1-15 HP motor platform (20-50 HP available)

### Dimensions (inches)

MODEL	A	B	C	D	E	F	G	H	J	K	L	M	N	P	UNIT WT. (lbs.)
<b>BIDI-10</b>	21-1/2	19-3/8	8-13/16	11-1/4	16-5/8	29-1/4	8-1/4	18-1/4	14-1/8	14-1/8	1-7/8	2	1-3/16	21-3/4	110
<b>BIDI-12</b>	25-1/16	21-3/16	10	13	18-1/2	31-3/4	9-13/16	20	14-1/8	14-1/8	2	2	1-7/16	24-1/8	138
<b>BIDI-13</b>	27-1/8	23	10-3/4	14-3/8	19-1/8	31-3/4	10-3/4	20-3/4	21-1/8	17	2	2	1-7/16	24-1/4	149
<b>BIDI-15</b>	29-13/16	25-5/16	11-3/4	15-3/4	21-3/8	34	11-13/16	23	21-1/8	17	2	2	1-7/16	28-1/2	177
<b>BIDI-16</b>	32-5/8	27-1/2	12-3/4	17-5/8	23-1/2	37-5/8	13	25-1/8	26-5/8	21-1/2	2	2	1-11/16	28-5/8	215
<b>BIDI-18</b>	35-3/4	30-1/8	13-7/8	19-3/8	25-3/4	39-7/8	14-3/8	27-3/8	29-3/4	24-1/8	2	2	1-11/16	30-7/8	237
<b>BIDI-20</b>	39	32-7/8	15	21-1/4	28	42-1/8	15-3/4	29-5/8	33	26-7/8	2	2	1-11/16	33-1/8	273
<b>BIDI-22</b>	43-1/8	36-1/8	16-3/8	23-5/8	31-1/8	46-3/4	17-3/8	33-1/4	40-1/8	33-1/8	2	3	2-1/4	37-1/4	421
<b>BIDI-24</b>	47-1/8	39-5/8	17-7/8	26-1/8	34-1/8	49-3/4	19-1/8	36-1/4	44-1/8	36-5/8	2	3	2-1/4	40-1/4	490
<b>BIDI-27</b>	51-5/8	43-3/8	19-1/2	28-5/8	37-3/4	53-3/8	21	39-7/8	48-5/8	40-3/8	2	3	2-1/4	43-7/8	565

**BIDI - 10**

Max. Wheel RPM: 4000

Max. H.P. 7-1/2

Shaft Dia: 1-3/16"

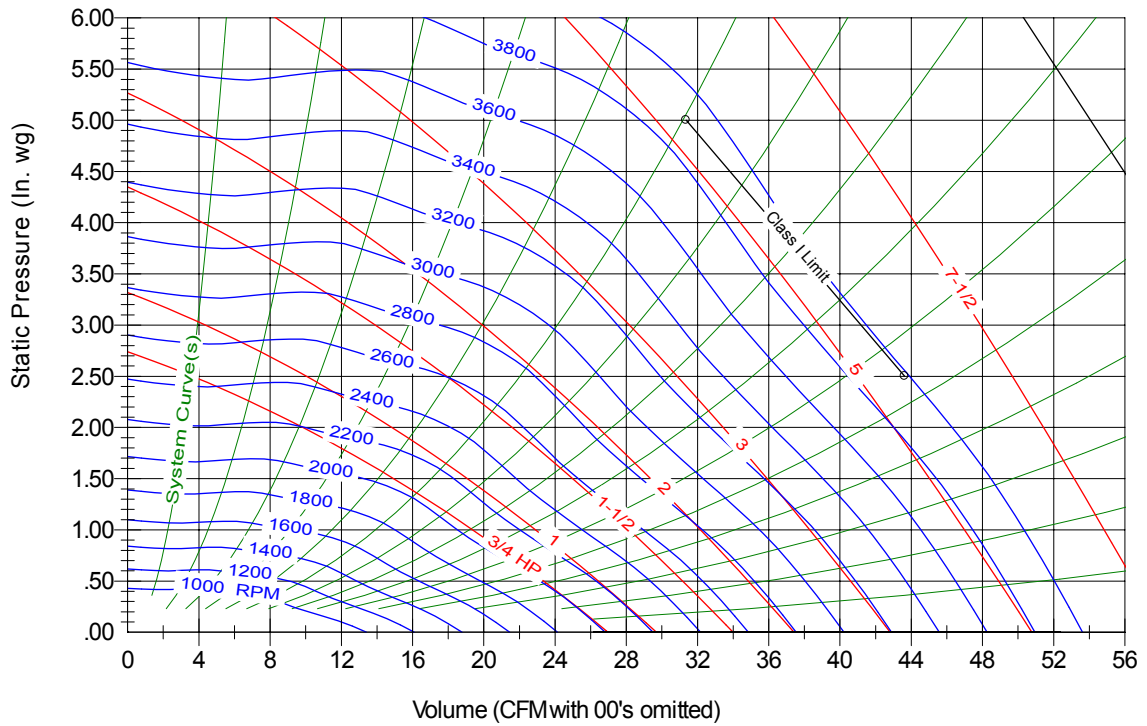

**BIDI - 12**

Max. Wheel RPM: 3400

Max. H.P. 7-1/2

Shaft Dia: 1-7/16"

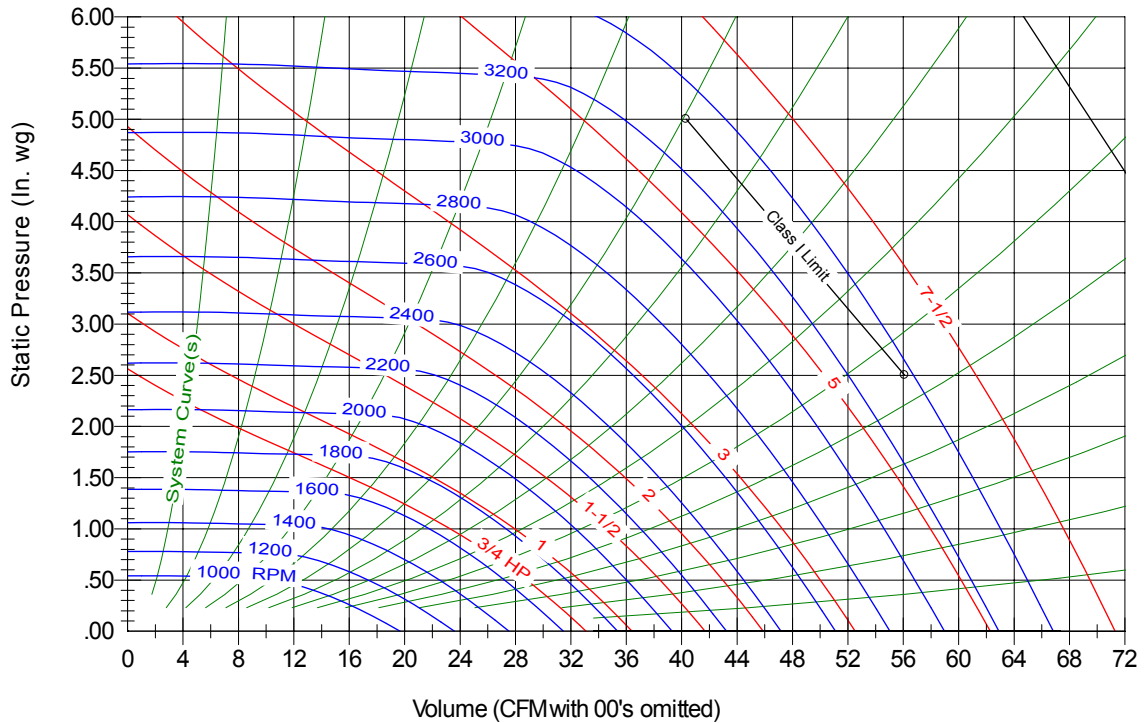

Power rating (BHP) does not include transmission losses. Performance certified is for installation type B: Free inlet, Ducted outlet. Performance ratings do not include the effect of appurtenances (accessories).



# BIDI - 13

Max. Wheel RPM: 3000

Max. H.P. 7-1/2

Shaft Dia: 1-7/16"

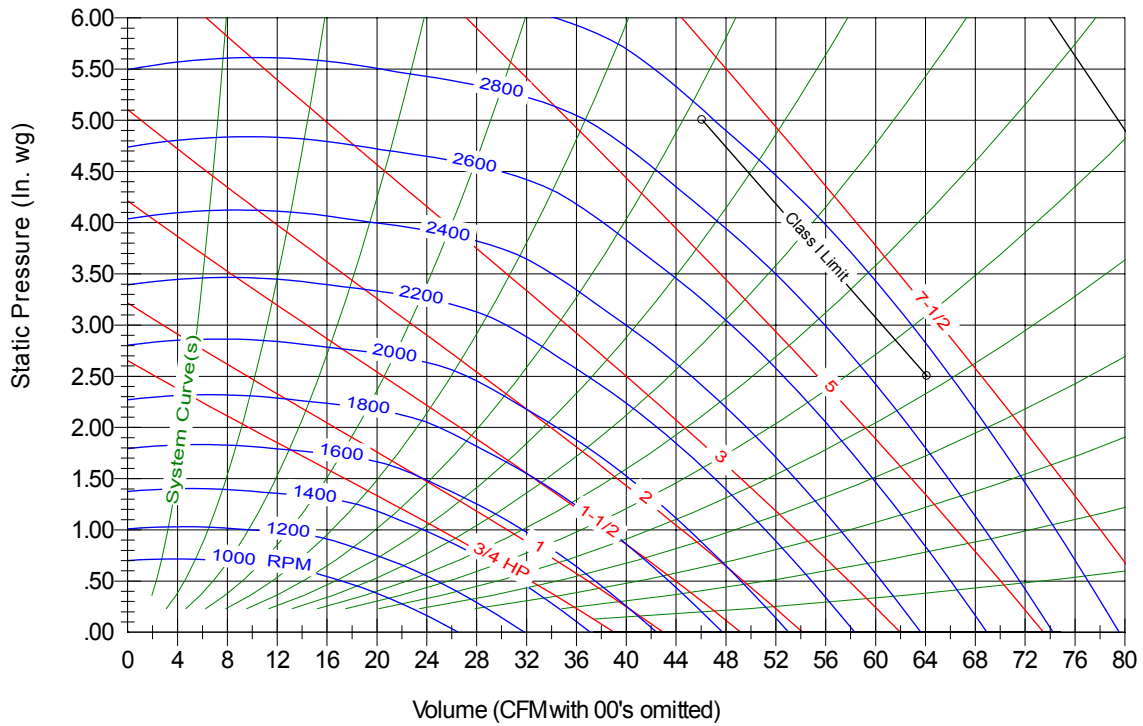

# BIDI - 15

Max. Wheel RPM: 2700

Max. H.P. 10

Shaft Dia: 1-7/16"

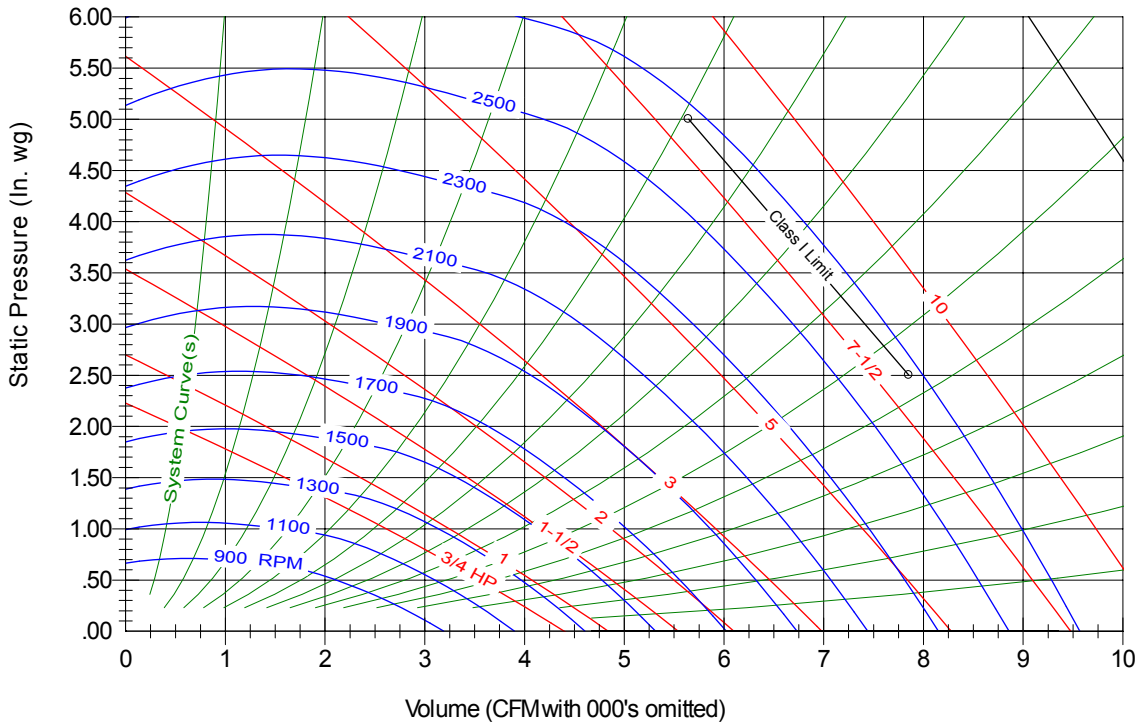

Power rating (BHP) does not include transmission losses. Performance certified is for installation type B: Free inlet, Ducted outlet. Performance ratings do not include the effect of appurtenances (accessories).

**BIDI - 16**

Max. Wheel RPM: 2500

Max. H.P. 15

Shaft Dia: 1-11/16"

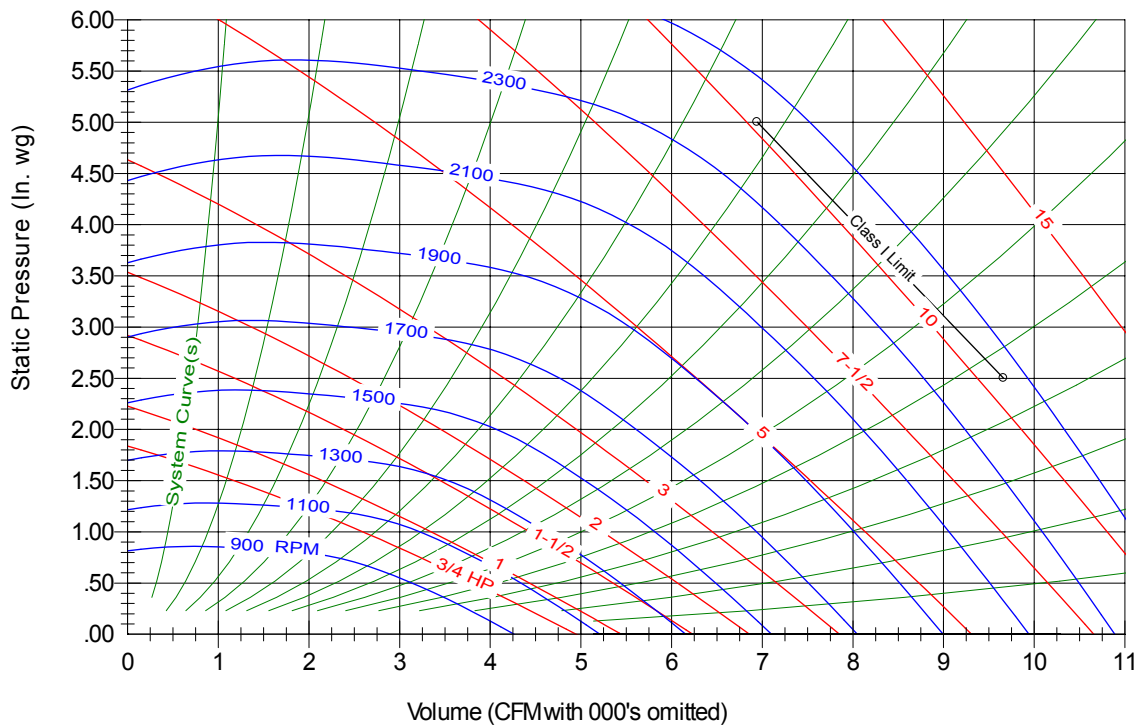

**BIDI - 18**

Max. Wheel RPM: 2200

Max. H.P. 15

Shaft Dia: 1-11/16"

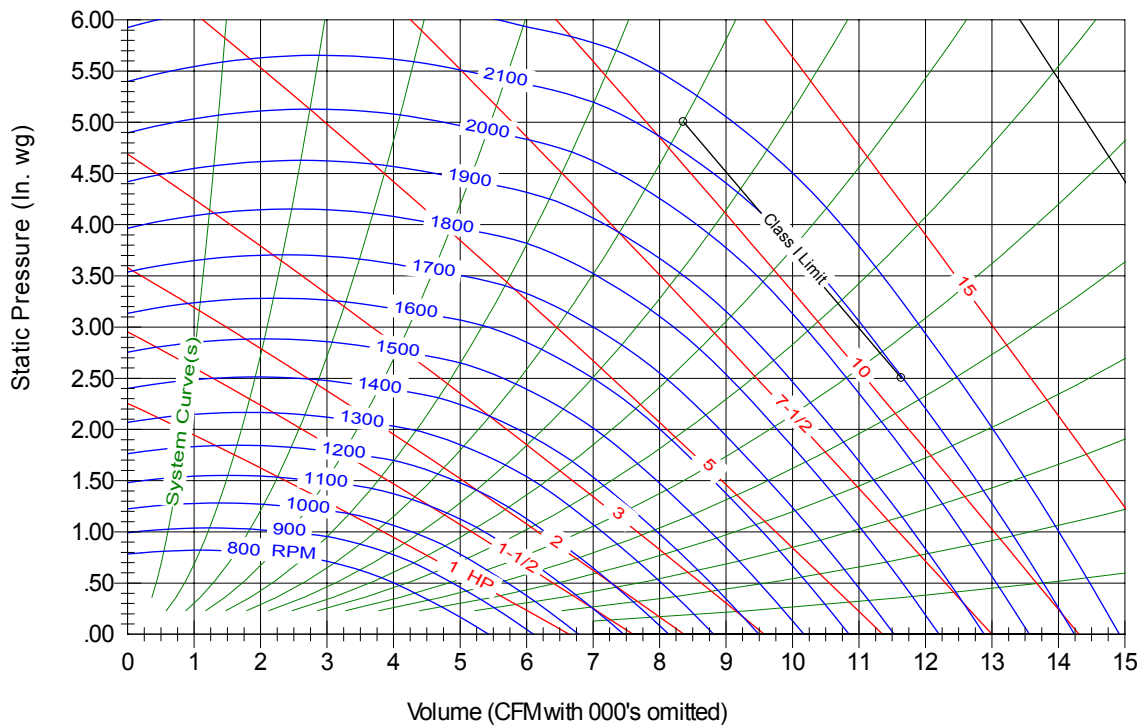

Power rating (BHP) does not include transmission losses. Performance certified is for installation type B: Free inlet, Ducted outlet. Performance ratings do not include the effect of appurtenances (accessories).



## BIDI - 20

Max. Wheel RPM: 1950

Max. H.P. 15

Shaft Dia: 1-11/16"

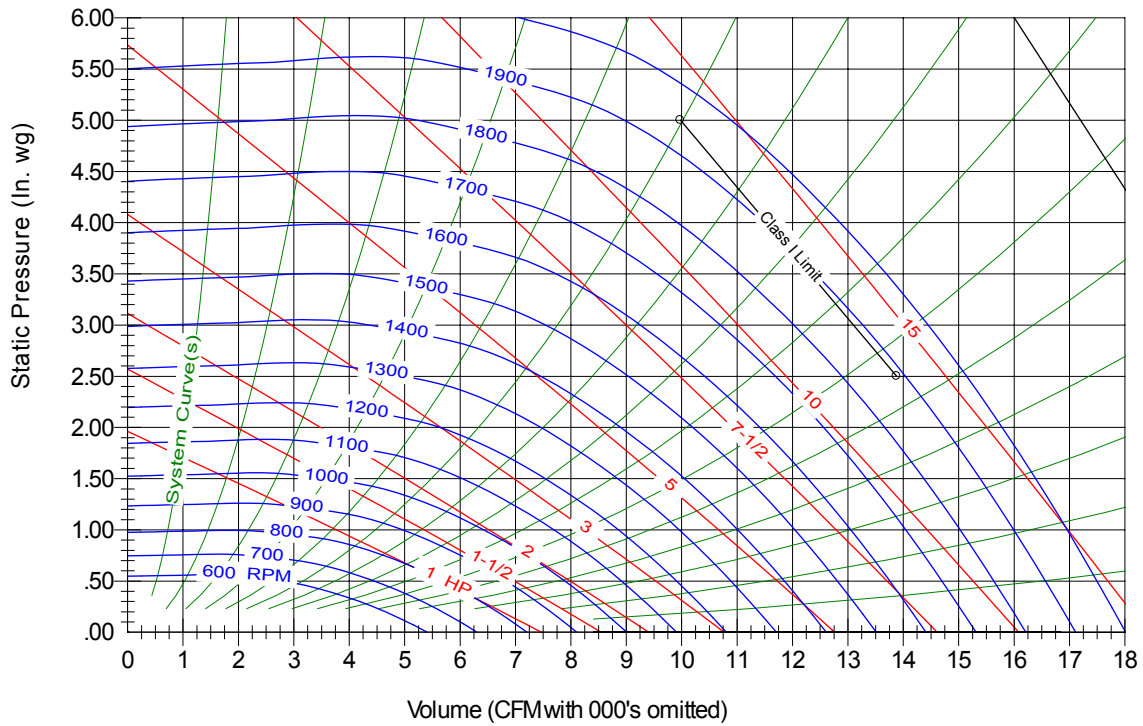

## BIDI - 22

Max. Wheel RPM: 1750

Max. H.P. 20

Shaft Dia: 2-1/4"

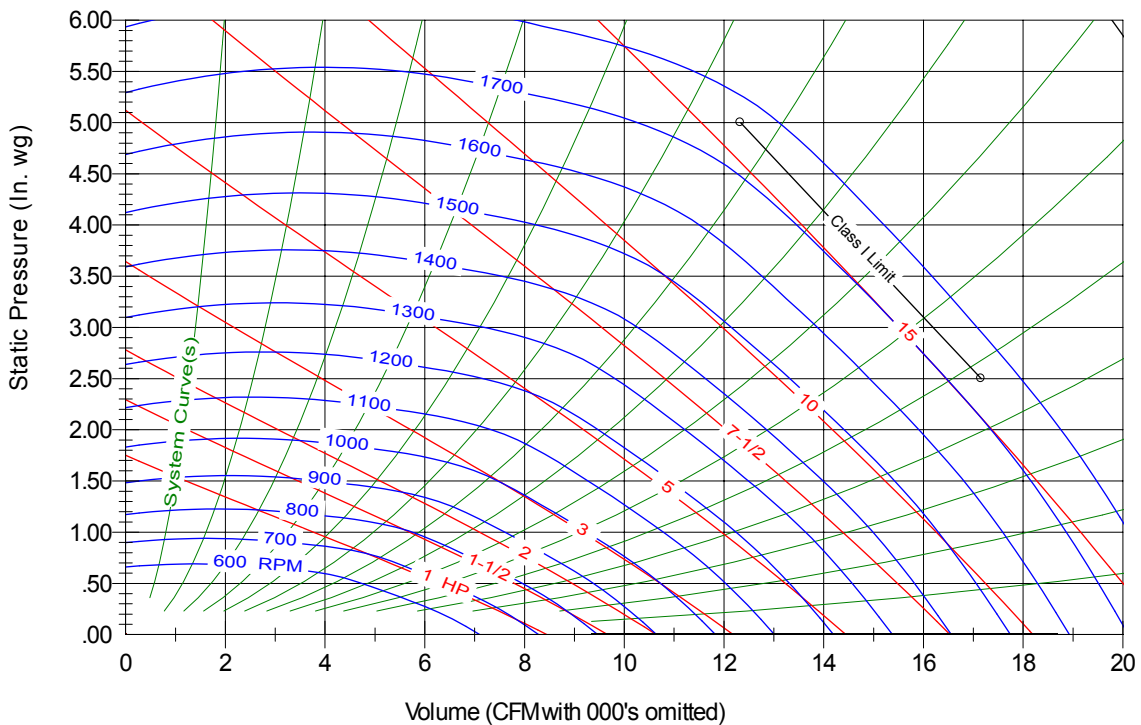

Power rating (BHP) does not include transmission losses. Performance certified is for installation type B: Free inlet, Ducted outlet. Performance ratings do not include the effect of appurtenances (accessories).

**BIDI - 24**

Max. Wheel RPM: 1600

Max. H.P. 20

Shaft Dia: 2-1/4"

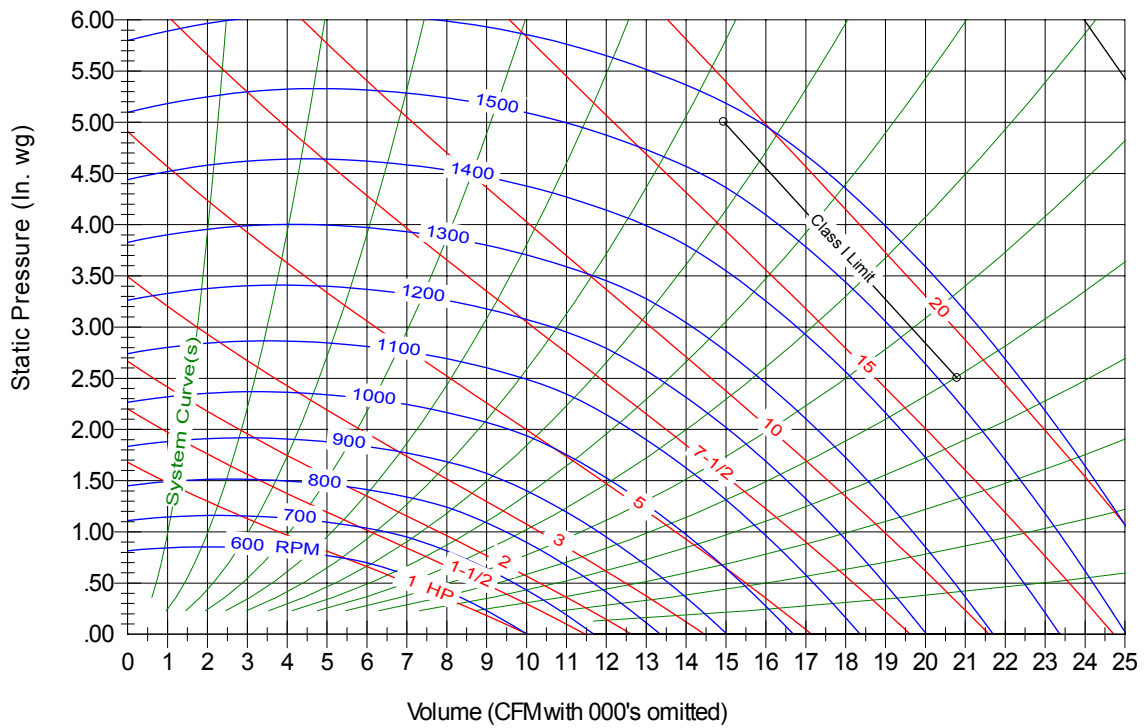

**BIDI - 27**

Max. Wheel RPM: 1450

Max. H.P. 25

Shaft Dia: 2-1/4"

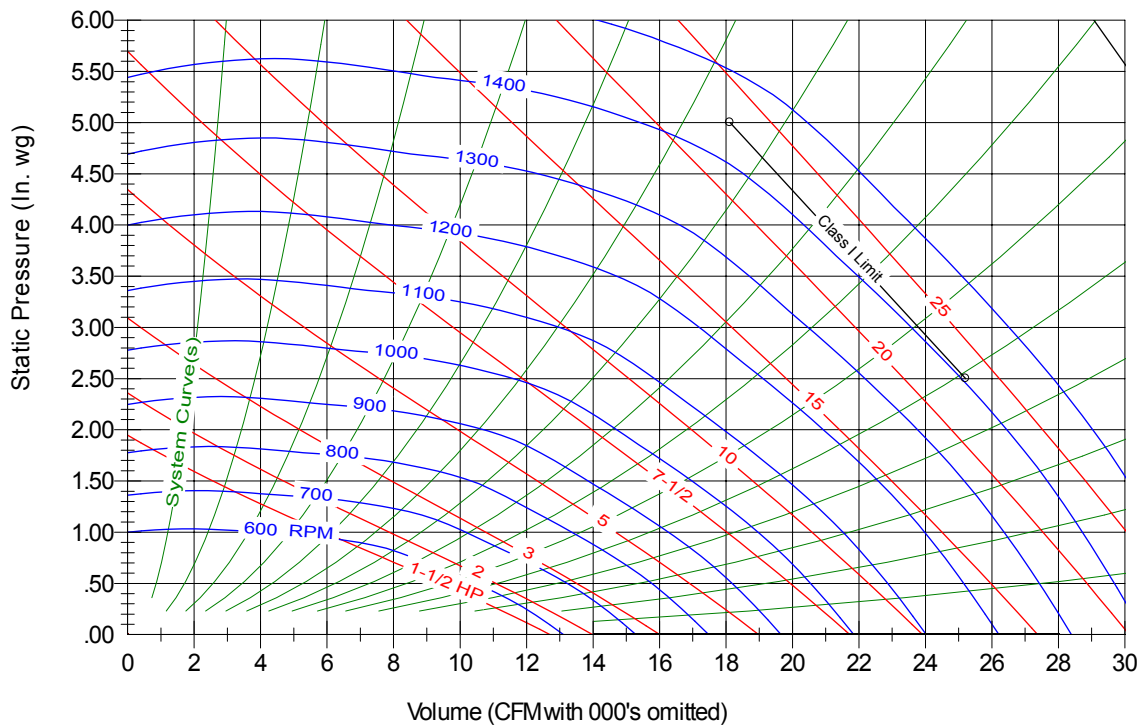

Power rating (BHP) does not include transmission losses. Performance certified is for installation type B: Free inlet, Ducted outlet. Performance ratings do not include the effect of appurtenances (accessories).



523 James Street,  
Delhi, Ontario N4B 2Z3 Canada

Tel: 519-582-2440

Fax: 519-582-0581

www.delhi-industries.com

sales@delhi-industries.com

## Other DELHI Catalogues

- Cat. #SS-30 \_\_\_\_ 7" - 36" Utility Blowers
- Cat. #SS-31 \_\_\_\_ Forward Curved Duct Blowers
- Cat. #SS-32 \_\_\_\_ Filtered Fresh Air Supply Units
- Cat. #SS-38 \_\_\_\_ Heating & Cooling Coils
- Cat. #SS-43 \_\_\_\_ Roof Mounted Exhausters
- Cat. #SS-44 \_\_\_\_ DWDI - BI Blowers
- Cat. #SS-45 \_\_\_\_ Direct Drive Utility Blowers
- Cat. #SS-48 \_\_\_\_ Plenum Fans
- Cat. #SS-49 \_\_\_\_ 7" - 36" FC Blowers
- Cat. #SS-50 \_\_\_\_ Backward Inclined Inline Blowers
- Cat. #SS-51 \_\_\_\_ Downblast Aluminum Exhausters
- Cat. #SS-52 \_\_\_\_ Direct Expansion Coils
- Cat. #SS-53 \_\_\_\_ "G" Direct Drive Blower With 3 Speed PSC Motor
- Cat. #SS-54 \_\_\_\_ Upblast Aluminum Exhausters

### WARRANTY

Delhi Industries Air Moving products are guaranteed for a period of one year (12 consecutive months) from the date of sale against manufacturing defects in material and workmanship when operating under normal conditions. Liability is limited to the replacement of defective parts. Labour and transportation costs are not included.

If a replacement is warranted the following MUST be provided:

1. Model of equipment
2. Date of manufacture
3. Original invoice reference number(s)

### REPRESENTED BY: